



Throttle Control Cable Adjustment/Inspection

NOTE: Perform the following inspections before adjusting the throttle control cable.

- The carburetor throttle cable play is correct
 - The engine is warmed-up to operating temperature.
- NOTE: The cooling fan should come on twice or more.
- The idle speed is correct.
 - The distance between the throttle control lever and the throttle control bracket is correct as shown in left column.

1. With the engine off, disconnect the throttle control cable from the throttle control lever.
2. Attach a weight of about 1.3 kg (2.6 lbs) to the accelerator pedal. Raise the pedal, then release it, this will allow the weight to remove the normal free play from the throttle cable.

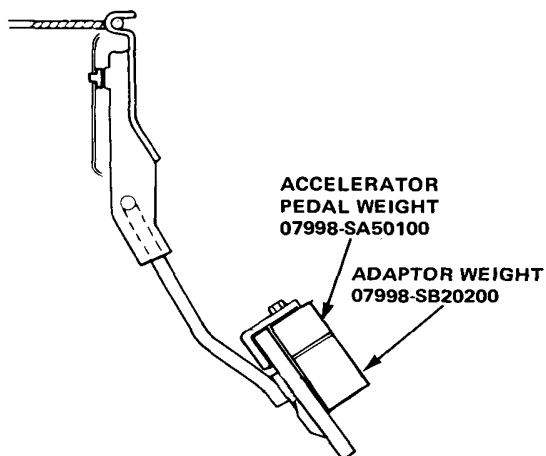

3. Secure the throttle control cable with clamps as shown.

L/H

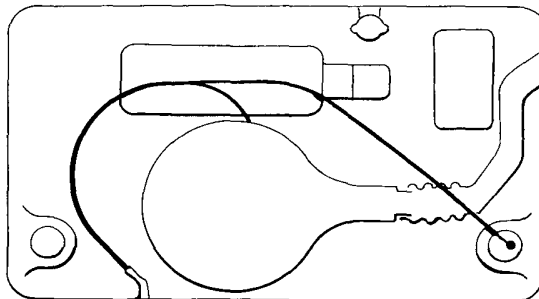

R/H

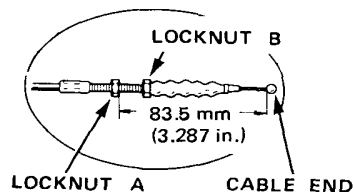
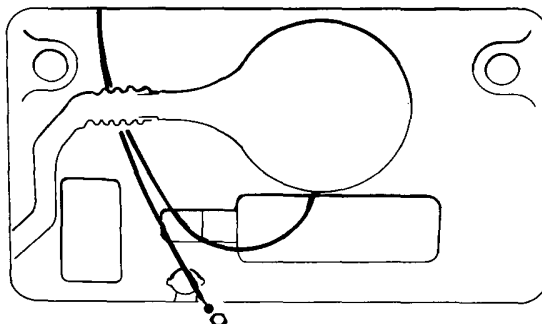

4. L/H: Lay the end of the throttle control cable on the R damper shock tower.
R/H: Lay the end of the throttle control cable on the engine hood latch.
5. Adjust the distance between the throttle control cable end and nut (A) to 83.5 mm (3.287 in.).
6. Insert the end of throttle control cable in the groove of the throttle control lever.

(cont'd)

Hondamatic

Throttle Control Cable Adjustment/ Inspection (Cont'd)

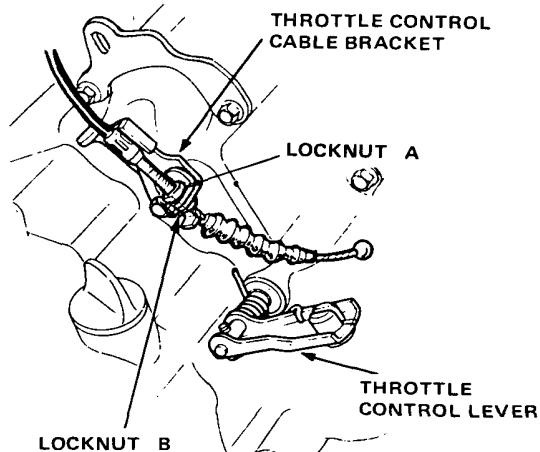

7. Insert the throttle control cable in the bracket and secure with lock nut (B).

NOTE: Make sure the cable is not kinked or twisted.

8. Check that the cable moves freely by depressing the accelerator.
9. Remove the weight on the accelerator pedal and push the pedal to make sure that there is the specified play at the throttle control lever.

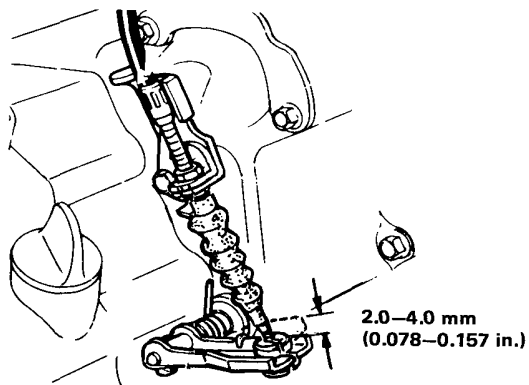

10. Start the engine and check the synchronization between the carburetor and the throttle control cable.

NOTE: The throttle control lever should start to move as engine speed increases.

- If the throttle control lever moves before engine speed increases, turn the cable lock nut A counter clockwise and re-tighten lock nut B.
- If the throttle control lever moves after engine speed increases, turn lock nut A clockwise and re-tighten the lock nut B.